

THIS DRAWING IS A CONTROLLED DOCUMENT.

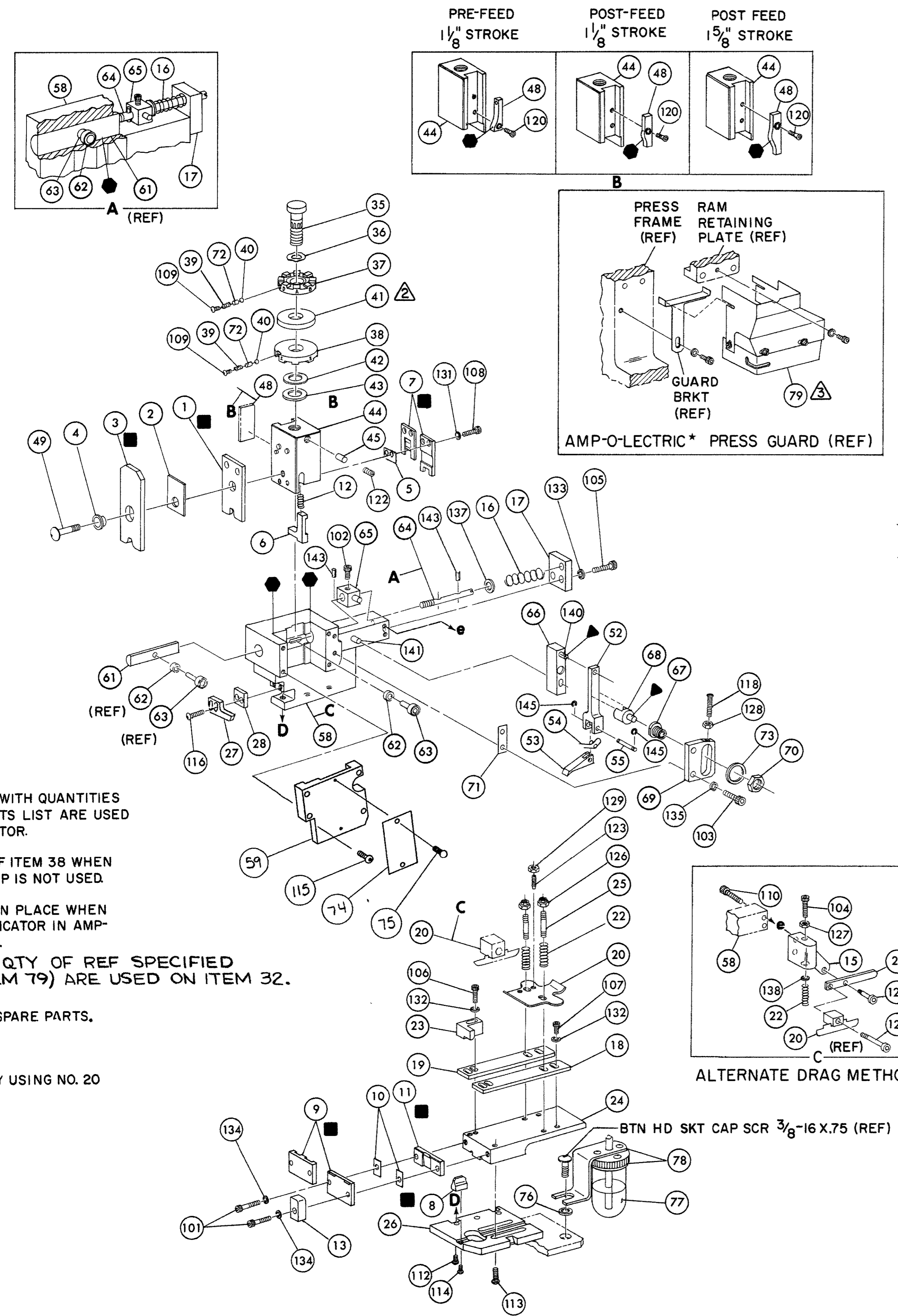

NOTES:

- 1. ONLY THE ITEMS WITH QUANTITIES SPECIFIED ON PARTS LIST ARE USED ON THIS APPLICATOR.
 - △ USED IN PLACE OF ITEM 38 WHEN INSULATION CRIMP IS NOT USED.
 - △ GUARD MUST BE IN PLACE WHEN OPERATING APPLICATOR IN AMP-O-LECTRIC PRESS.
 - 4. ITEMS WITH QTY OF REF SPECIFIED (EXCEPT ITEM 79) ARE USED ON ITEM 32.
- KEY:**
- RECOMMENDED SPARE PARTS.
 - ▲ LUBRICATE DAILY USING NO. 20 MACHINE OIL.
 - GREASE LIGHTLY.

REF	PART NO	DESCRIPTION	QTY	PART NO	DESCRIPTION	ITEM NO	
REF	21045-3	RING, RETAINING 'C' (.187 DIA) FEED PIN	145	REF	454220-1	CAP, RAM	59
REF	5-21028-1	PIN, SLOT SPG (.12 DIA X .50) FD ADJ ROD	143	REF	453736-1	HOUSING	58
REF	1-21030-7	PIN, DOWEL (.187 DIA X 1.50) HOUSING	142				57
REF	1-21030-1	PIN, DOWEL (.187 DIA X .50) LEVER	141	REF	240624-1	PIN, FEED FINGER	56
			140	REF	691499-1	SPRING, FEED FINGER	55
			139	REF	240635-1	FINGER, FEED	54
			138	REF	240634-3	LEVER, TERMINAL	53
REF	22260-5	WASHER, FLAT (NO 6) DRAG SPRING	137				52
REF	21899-4	WASHER, FLAT (5/16 DIA) SCR ADJ	136				51
			135				50
REF	21024-5	WASHER, LOCK (NO 10) FEED ADJ PLATE	134	1	7-21002-9	BOLT, CRIMPER	49
REF	21024-5	WASHER, LOCK (NO 10) SHEAR PLATES	133	1	690501-4	CAM, POST FEED 1 5/8 STROKE	48
REF	21024-4	WASHER, LOCK (NO 8) STRIP GUIDE	132				47
REF	21024-4	WASHER, LOCK (NO 8) SHEAR BLADE	131	1	690191-1	PLUG, NYLON	46
			130	1	455674-1	RAM	45
			129	1	690125-1	WASHER, LAMINATED	44
REF	21068-5	NUT, HEX MACH (6-32) FD ADJ PLATE	128	1	690124-1	WASHER, RAM	43
			127	1	690223-1	SPACER, DISC	42
			126	1	23241-6	BALL, STEEL	41
			125	1	690170-1	SPRING, COMPRESSION	40
			124			DISC, INSULATION	39
			123	1	692155-5	DISC, WIRE	38
			122	1	22480-5	WASHER, SPRING	37
			121	1	690212-1	POST, RAM	36
			120				35
			119				34
REF	3-21064-2	SCR, RD HD MACH (6-32 X 1.50) FEED ADJ	118	1	458980-2	APPLICATOR, BASIC (SUB ASSY)	33
			117				32
			116				31
			115				30
REF	2-21002-9	SCR, BTN HD SKT CAP (10-32 X .75) HSG CAP	114				29
REF	22733-8	SCR, BTN HD SKT CAP (8-32 X .38) (LOC-WEL) ANVIL	113	1	462505-1	SPACER, STRIPPER	28
			112				27
REF	3-21002-3	SCR, BTN HD SKT CAP (1/4-20 X .50) STR GDE PL	111	REF	455676-1	PLATE, BASE	26
REF	2-22733-8	SCR, BTN HD SKT CAP (1/4-20 X .62) BASE PL	110	2	22354-8	DRAG, STUD	25
			109	1	455678-1	PLATE, STRIP GUIDE	24
			108	1	240825-2	PLATE, STRIP HOLD	23
			107	2	4-22281-1	SPRING, DRAG	22
			106	1	240636-1	LEVER, DRAG	21
			105	1	454177-1	DRAG, STOCK	20
REF	3-21000-7	SCR, SKT HD CAP (8-32 X .50) SHEAR BLADE	104	1	454204-5	GUIDE, STRIP (REAR)	19
REF	3-21000-9	SCR, SKT HD CAP (10-32 X 1.00) DRAG SPRING	103	1	454204-5	GUIDE, STRIP (FRONT)	18
REF	3-21000-6	SCR, SKT HD CAP (10-32 X .62) FD ADJ PLATE	102	REF	454178-1	GUIDE, FEED ROD	17
REF	3-21000-4	SCR, SKT HD CAP (10-32 X .38) PIVOT BLK	101	REF	4-22284-9	SPRING, FEED RETURN	16
REF	455750-4	GUARD ASSY	79			ADAPTER, DRAG	15
			78				14
			77				13
			76	1	240644-1	SPACER, HOLD DOWN	12
			75	2	1-240645-5	SPRING, HOLD DOWN	11
			74	1	240642-4	PLATE, REAR SHEAR	10
			73	1	240642-4	PLATE, FRONT SHEAR	9
REF	458109-1	WASHER, FLAT (SPECIAL)	72	1	1-240654-2	ANVIL	8
			71	1	5-240651-3	BLADE, SLUG	7
			70			HOLD DOWN, TERMINAL	6
			69	1	4-240641-6	SPACER, SHEAR BLADE	5
			68			SPACER, TUBULAR	4
			67			CRIMPER, INSULATION	3
			66			SPACER, INSULATION	2
			65	1	1-456406-5	CRIMPER, WIRE	1

CRIMPING DATA				APPLICATOR WILL APPLY	
PAD LTR	CRIMP HEIGHT	WIRE SIZE	WIRE STRIP LENGTH		
A	.065	16			505002
B	.058	18			770325
C	.055	20			
D	NOT USED				
CRIMP	SIZE	TYPE	FEED	APPL INST	
WIRE	.090	F	.630	A1 8039	
INSUL					
WIRE RANGE		INSULATION RANGE		PRESS NO	
20-16					
REMARKS: AMPOMATOR					
CAUTION: DO NOT USE LUBRICATION ON TERM. STRIP					
FEED OFF RECEPTACLE					

REMARKS	NO	REV
	114-2019	
APPL USED ON MACHINE PART NO	MACH SERIAL NO	DISTRIBUTION
CUSTOMER NAME	APPL SERIAL NO	ORIGINAL
ADDRESS	PURCHASE ORDER	CUSTOMER COPY
CITY	ENG APP	FIELD ENG COPY

EL 0150-8519-98	1/6	1/28	SET UP PAGE 10-1
E 0150-8779-96	1/4	1/28	458638-1500
D 0150-8577-96	1/6	1/28	DR 0/7/15 APP 10-7-1
C ECA A165288	1/28	1/28	1/28
B DARKENED	1/28	1/28	1/28
A REV PER EBU R25484	1/28	1/28	1/28
A REV ITEM 37 PER R2468	1/28	1/28	1/28

NAME: MINIATURE QUICK CHANGE APPLICATOR
END FEED (CLUSTER PIN RECEPT.)