

THIS DRAWING IS UNPUBLISHED. RELEASED FOR PUBLICATION
 © COPYRIGHT 19 BY AMP INCORPORATED. ALL INTERNATIONAL RIGHTS RESERVED.

PROJ CODE	LOC	DIST	P	F	ZONE	LTR	DESCRIPTION	DATE	APPD
4092	DF	SO				G	REDRAWN & ADDED 1-865765-1 & 1-865765-2 PER NPR'S 89-0342 & 89-0343	T.S. 8-18-89	WS
			✓			H	ADD -9 PER 0600-1422-93	CT 11-93	SG
			✓	✓		J	REV PER 0600-6810-97 JB	03-98	DE

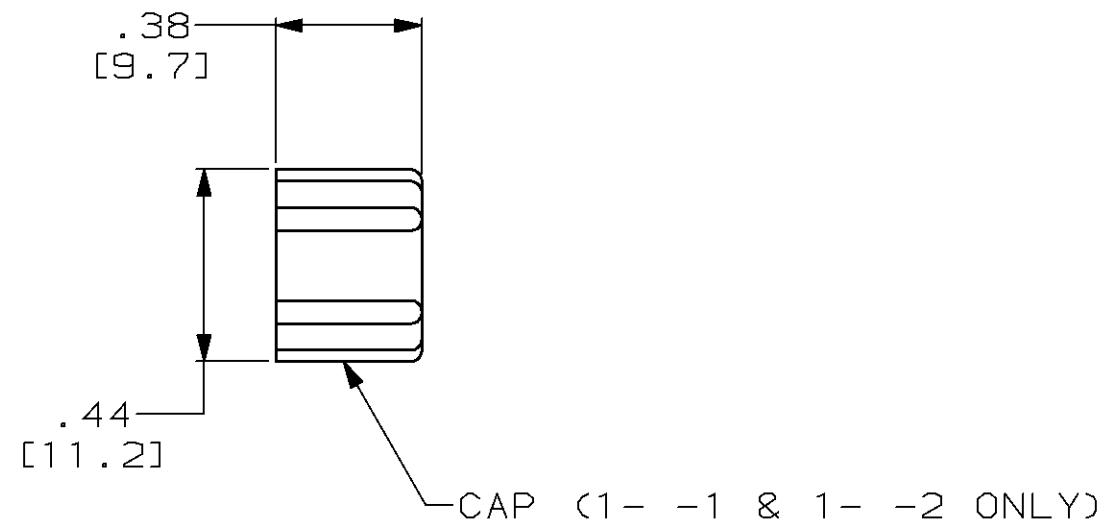
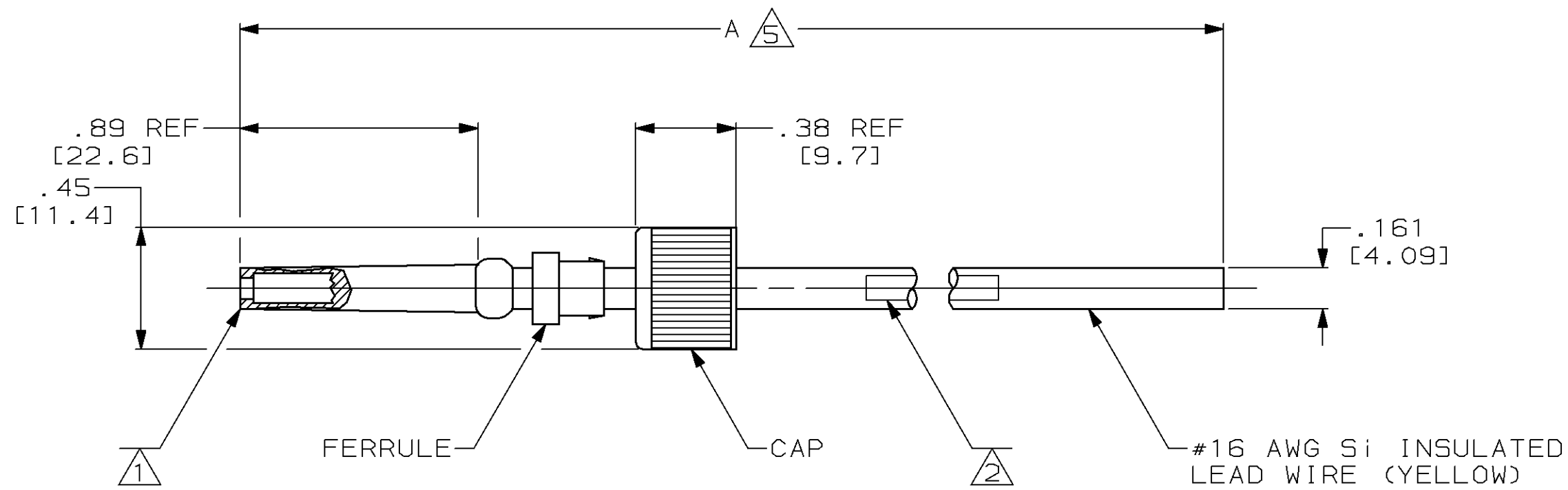

	12.00 [304.8]	1-865765-2
	18.00 [457.2]	1-865765-1
NOT RELEASED	---	1-865765-0
	36.00±.36 [914.4±9.1]	865765-9
NOT RELEASED	---	865765-8
	24.00 [609.6]	865765-7
OBSELETE	336.00±3.36 [8534.4±85.3]	865765-6
	72.00±.72 [182.8±18.3]	865765-5
	12.00 [304.8]	865765-4
OBSELETE	11.00 [279.4]	865765-3
OBSELETE	240.00±2.40 [6096.±61.0]	865765-2
	48.00±.46 [1219.2±12.2]	865765-1

- ① TO MATE WITH AMP LGH 1/2L RECEPTACLE WITH A .89 BARREL LENGTH.
- ② MARK PER MIL-STD-130.
- 3. OPERATING CONDITIONS: 15KVDC TO 70,000 FEET AT -55°C TO +125°C.
- 4. DIMENSIONS IN BRACKETS ARE IN MILLIMETERS. METRIC EQUIVALENTS ARE BASED UPON 1.00 inch = 25.4 mm.
- ⑤ TOLERANCE OF LEAD LENGTH:
UP TO 24 INCHES ±.12
24 INCHES AND UP ±1%

		A ⑤	PART NUMBER
DO NOT SCALE PRINT. UNLESS SPECIFIED DIMENSIONS IN INCHES [mm]	DR 8-18-89 T. SHUEY	AMP INCORPORATED Harrisburg, Pa. 17105	
TOLERANCES ON: 2 PLC DEC ± .12 [3.0] 3 PLC DEC ± .005 [0.13] ANGLES ±	CHK 9-5-89 W. SHATTO		
MATERIAL	APPD 9-5-89 W. SHATTO	NAME	
	APPD 9-5-89 T. SHUEY	LEAD ASSEMBLY, LGH 1/2L	
	PRODUCT SPEC	POSITIVE STOP	
FINISH	APPLICATION SPEC	SIZE	CAGE CODE
		C	00779
	WEIGHT	DRAWING NO	865765
		SCALE	SHEET
		2:1	1 OF 1

865765